

MAXIMUM CAPACITY (LBS)								
FASTENER	#	EDGE DIST. (IN)	EMBED (IN)	#10 <sup>1</sup> SDS T-W	#10 <sup>2</sup> SDS HD-T	UPLIFT- P1		
						423 HD14	423 HD16	
						423HD	HUS-H 3/8" Dia	1
HUS-H 1/2" Dia	1	2.75	3	4	2		745	650
1/2" HIT HY 150 MAX	1	1.75	4.5	6	3		1095	650
Kwik Bolt 3 1/2" Dia.	1	1.75	3	4	2		645	645

<sup>1</sup> For 423HD16, T-W = 3 - #10 SDS    <sup>2</sup> For 423HD16, HD-T = 2 - #10 SDS

MAXIMUM CAPACITY (LBS)							
FASTENER	#	EDGE DIST. (IN)	EMBED (IN)	#10 SDS T-W	#10 SDS HD-T	UPLIFT P1	
426HD14	HUS-H 1/2" Dia	1	2.75	3	4	2	745
	HUS-H 5/8" Dia	1	2.75	4	6	3	1175
	1/2" HIT HY 150 MAX	1	1.75	4.5	6	3	1095
	5/8" HIT HY 150 MAX	1	1.75	5.625	6	3	1240

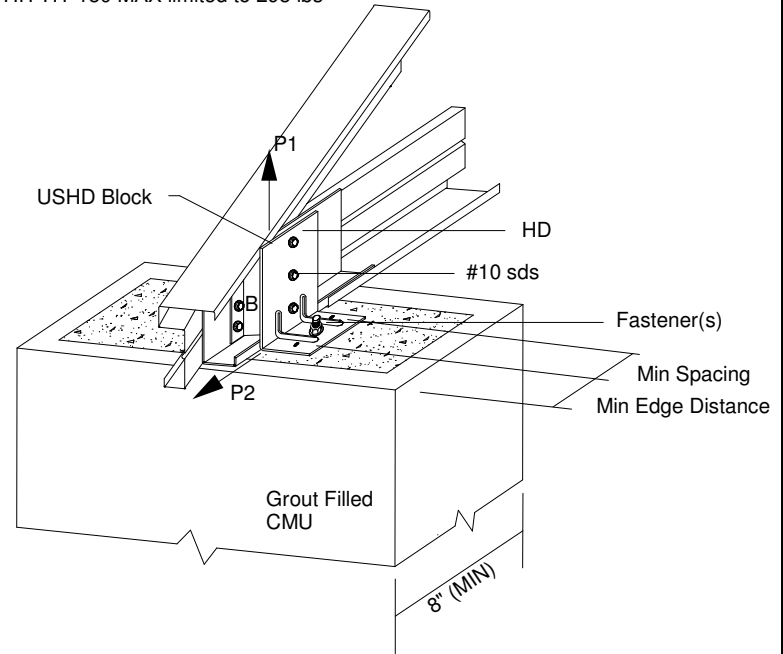
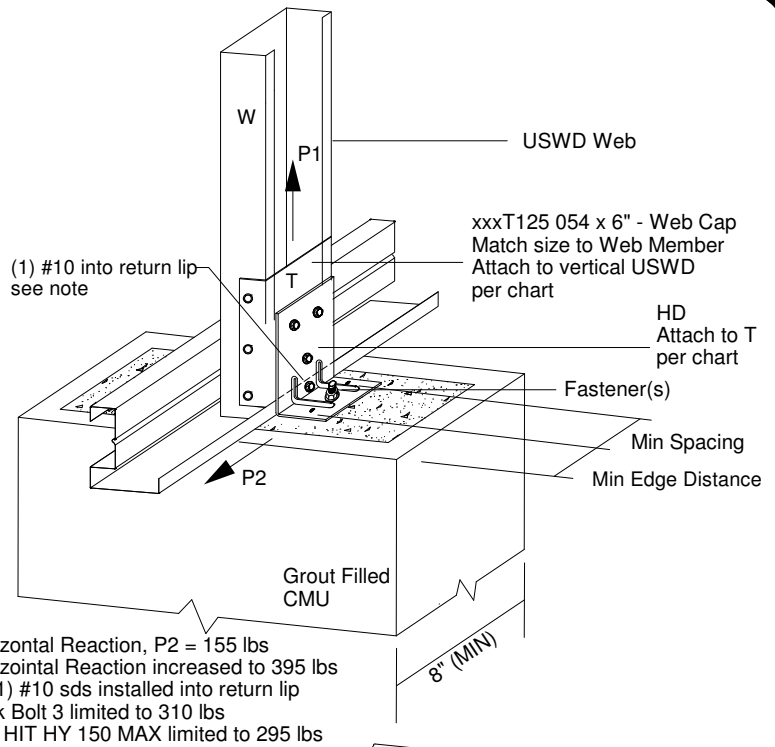

MAXIMUM CAPACITY (LBS)								
FASTENER	#	EDGE DIST. (IN)	EMBED (IN)	#10 <sup>1</sup> SDS HD-B	UPLIFT- P1		HORIZ P2	
					423 HD14	423 HD16		
					423HD	HUS-H 3/8" Dia		1
HUS-H 1/2" Dia	1	2.75	3	2		745	650	475
1/2" HIT HY 150 MAX	1	1.75	4.5	3		1095	650	295
Kwik Bolt 3 1/2" Dia.	1	1.75	3	2		645	645	310

<sup>1</sup> For 423HD16, HD-B = 2 - #10 SDS

MAXIMUM CAPACITY (LBS)							
FASTENER	#	EDGE DIST. (IN)	EMBED (IN)	#10 SDS HD-B	UPLIFT P1	HORIZ P2	
426HD14	HUS-H 1/2" Dia	1	2.75	3	2	745	475
	HUS-H 5/8" Dia	1	2.75	4	3	1175	535
	1/2" HIT HY 150 MAX	1	1.75	4.5	3	1095	295
	5/8" HIT HY 150 MAX	1	1.75	5.625	4	1240	400

- 1) Min. screw spacing & edge distance = 9/16".
- 2) Refer to the Hilti Product Technical Guide for installation requirements and application limits.
- 3) Equivalent fasteners may be substituted.
- 4) Place fastener in line w/ holes in HD14.
- 5) HD product specified is manufactured by Aegis Metal Framing. Any substitution is prohibited.
- 6) Minimum Grout f<sub>c</sub> = 1500 psi
- 7) This detail does not indicate or imply that the depicted bearing is structurally adequate for the loads shown. Design of bearing is req'd.
- 8) Max. Reactions shown are non-concurrent.



www.AegisMetalFraming.com

14515 N. Outer 40 Drive - Suite 110  
Chesterfield, MO 63017

Phone: (866) 902-3447 Fax: (314) 434-5234

## USD TRUSS TO BEARING CONNECTION 423HD / 426HD CMU

Revised 5/20/11 - New 423HD14, 423HD16 and 426HD14

DETAIL NO.

# D-CMU-1.1

CATEGORY

STANDARD DETAILS

DATE

3/2012